

## Outline Dimensions

UG2852

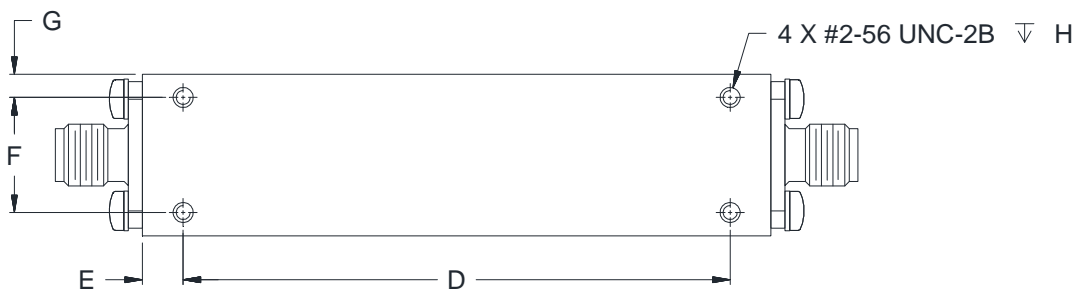
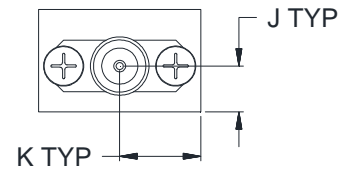
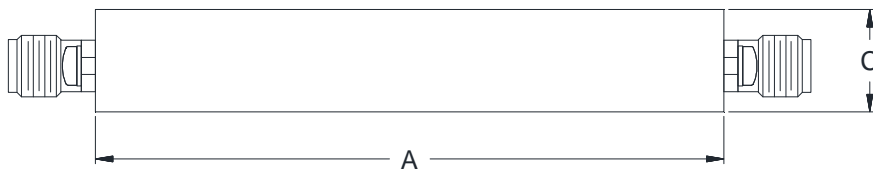
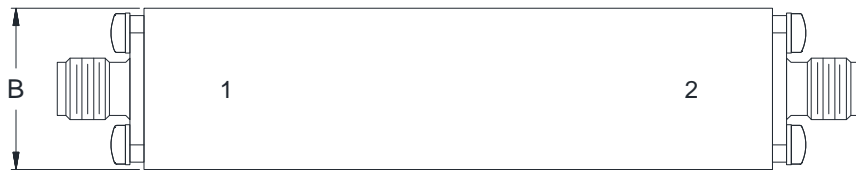

CASE#	A	B	C	D	E	F
UG2852	2.70 (68.5)	.70 (17.7)	.44 (11.2)	2.347 (59.61)	.18 (4.4)	.495 (12.57)

CASE#	G	H	J	K	WT. GRAMS
UG2852	.10 (2.5)	.100 (2.54)	.20 (5.0)	.35 (8.8)	75

Dimensions are in inches (mm). Tolerances: 2 Pl.  $\pm .100$ ; 3 Pl.  $\pm .015$

### Notes:

1. Case material: Brass and Aluminum alloy.
2. Case Finish: Powder coated over silver plating.
3. Refer to the individual model data sheet for the type of connectors available.



P.O. Box 350166, Brooklyn, New York 11235-0003 (718) 934-4500 Fax (718) 332-4661 For detailed performance specs & shopping online see Mini-Circuits web site



The Design Engineers Search Engine Provides ACTUAL Data Instantly From MINI-CIRCUITS At: [www.minicircuits.com](http://www.minicircuits.com)

RF/IF MICROWAVE COMPONENTS