

Case Style

L

L19

L20

Outline Dimensions

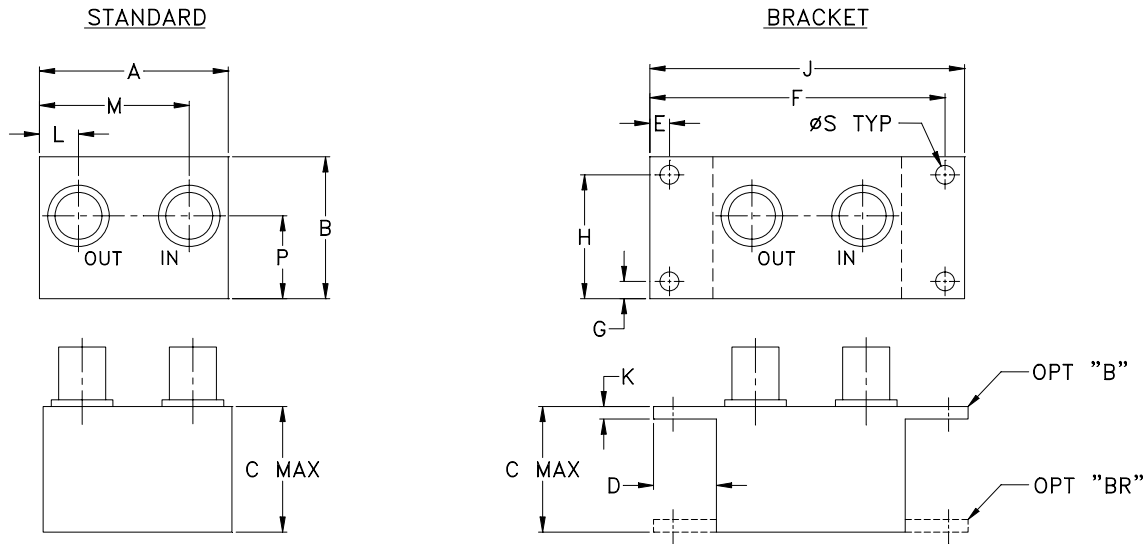

CASE#	A	B	C	D	E	F	G	H	J	K	L	M	N
L19	1.50 (38.10)	1.13 (28.70)	1.00 (25.40)	.50 (12.70)	.155 (3.94)	2.345 (59.56)	.138 (3.51)	.987 (25.07)	2.50 (63.50)	.10 (2.54)	.31 (7.87)	1.19 (30.23)	--
L20	2.25 (57.15)	1.38 (35.05)	1.24 (31.50)		.150 (3.81)	3.100 (78.74)		1.238 (31.45)	3.25 (82.55)		.40 (10.16)	1.86 (47.24)	--

CASE#	P	Q	R	S	WT. GRAMS
L19	.66 (16.76)	--	--	.150 (3.81)	37.0
L20	.64 (16.26)	--	--		74.0

Dimensions are in inches (mm). Tolerances: 2 Pl. $\pm .03$; 3 Pl. $\pm .015$

Notes:

- Case material: Aluminum alloy.
- Case finish:
 - For RoHS Case Styles: Clear chemical conversion coating, non-chrome or trivalent chrome based.
 - For Non-RoHS Case Styles: Yellow hexavalent chrome based conversion coating.

Due to transition from non-RoHS to RoHS, models will be supplied with either case style finish until the non-RoHS case inventory is depleted.
- Mounting bracket available on request. For bracket mounted on connector end add suffix B to part number and add \$5.00 to unit cost. For bracket mounted on the rear, add suffix BR to part number and add \$1.50 to unit cost.



INTERNET <http://www.minicircuits.com>

P.O. Box 350166, Brooklyn, New York 11235-0003 (718) 934-4500 Fax (718) 332-4661

Distribution Centers NORTH AMERICA 800-654-7949 • 417-335-5935 • Fax 417-335-5945 • EUROPE 44-1252-832600 • Fax 44-1252-837010

Mini-Circuits ISO 9001 & ISO 14001 Certified