

Outline Dimensions

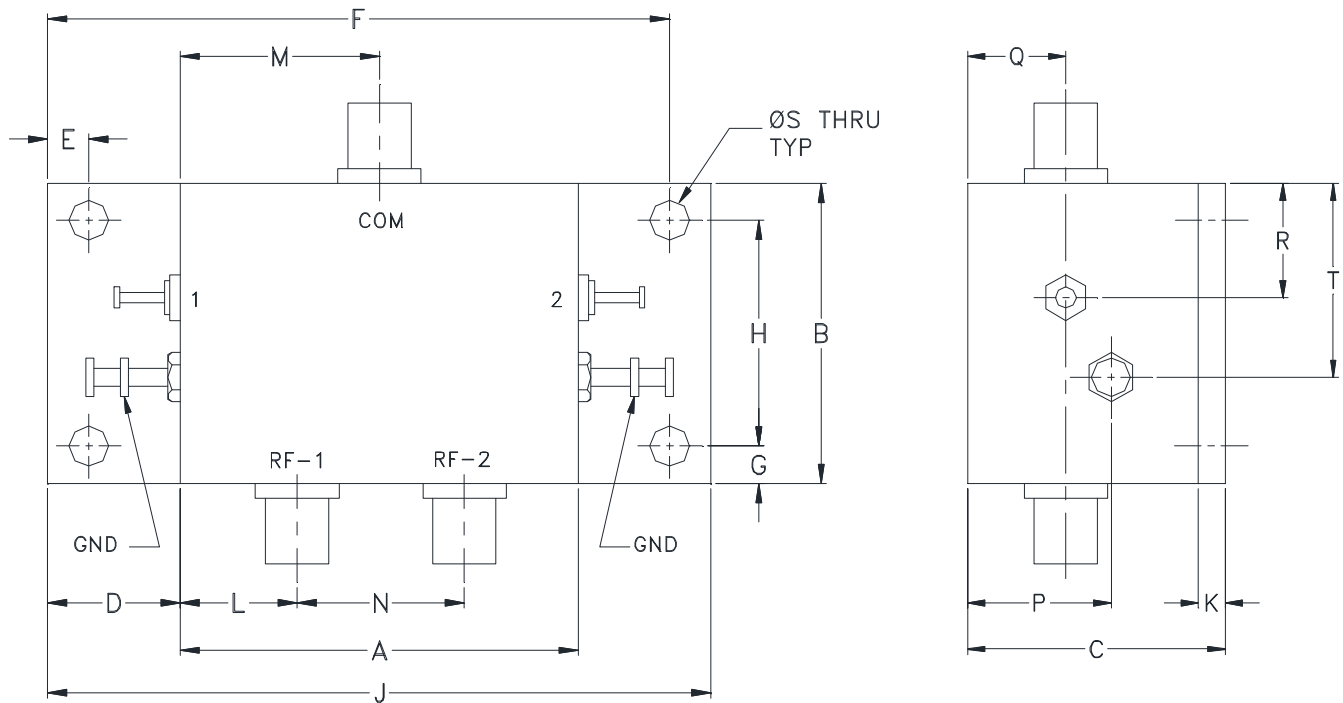

CASE#	A	B	C	D	E	F	G	H	J	K	L	M	N
JJ77	1.50 (38.10)	1.13 (28.70)	1.0 (25.40)	.50 (12.70)	.155 (3.94)	2.345 (59.56)	.14 (3.56)	.850 (21.59)	2.50 (63.50)	.13 (3.18)	.44 (11.18)	.75 (19.05)	.63 (16.00)

CASE#	P	Q	R	S	T	WT. GRAMS
JJ77	.57 (14.35)	.39 (9.78)	.43 (10.92)	.150 (3.81)	.73 (18.54)	50.0

Dimensions are in inches (mm). Tolerances: 2 Pl. + .03; 3 Pl. + .015

Notes:

1. Case material: Aluminum alloy.
2. Case finish:

For RoHS Case Styles: Clear chemical conversion coating, non-chrome or trivalent chrome based.



INTERNET <http://www.minicircuits.com>

P.O. Box 350166, Brooklyn, New York 11235-0003 (718) 934-4500 Fax (718) 332-4661

Distribution Centers NORTH AMERICA 800-654-7949 • 417-335-5935 • Fax 417-335-5945 • EUROPE 44-1252-832600 • Fax 44-1252-837010

Mini-Circuits ISO 9001 & ISO 14001 Certified