

Case Style

FF

Outline Dimensions

FF2607

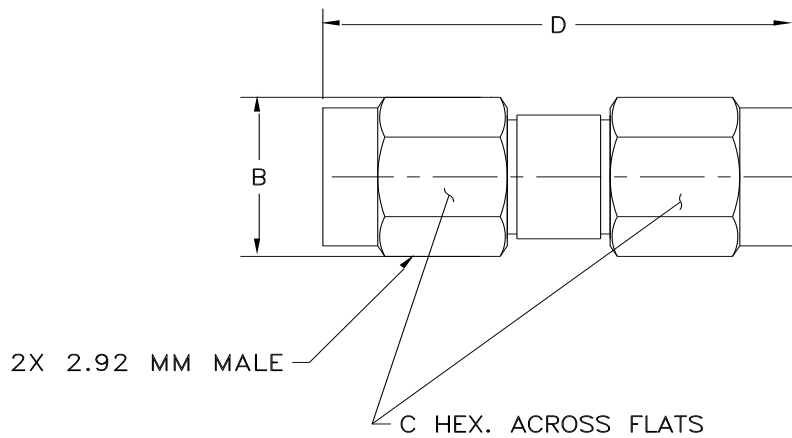

CASE #.	A	B	C	D	E	WT GRAMS
FF2607	--	.36 (9.14)	.312 (7.92)	.91 (23.1)	--	6.5 MAX

Dimensions are in inches (mm). Tolerances: 2Pl. \pm .03; 3Pl. \pm .015

Notes:

1. Case material: Passivated Stainless steel.

 **Mini-Circuits**[®]
ISO 9001 ISO 14001 CERTIFIED

ALL NEW



P.O. Box 350166, Brooklyn, New York 11235-0003 (718) 934-4500 Fax (718) 332-4661 For detailed performance specs & shopping online see Mini-Circuits web site

The Design Engineers Search Engine Provides ACTUAL Data Instantly From MINI-CIRCUITS At: www.minicircuits.com



RF/IF MICROWAVE COMPONENTS